

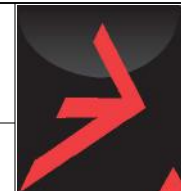

Dogfish Head Brewings & Eats

Acoustic Treatment Recommendations

Cameron Girard - Acoustic Design Consultant



AcousticsFirst[®]
CORPORATION
2247 Tomlyn Street, Richmond, VA 23230
PH: (804) 342-2900 FX: (804) 342-1107
www.AcousticsFirst.com

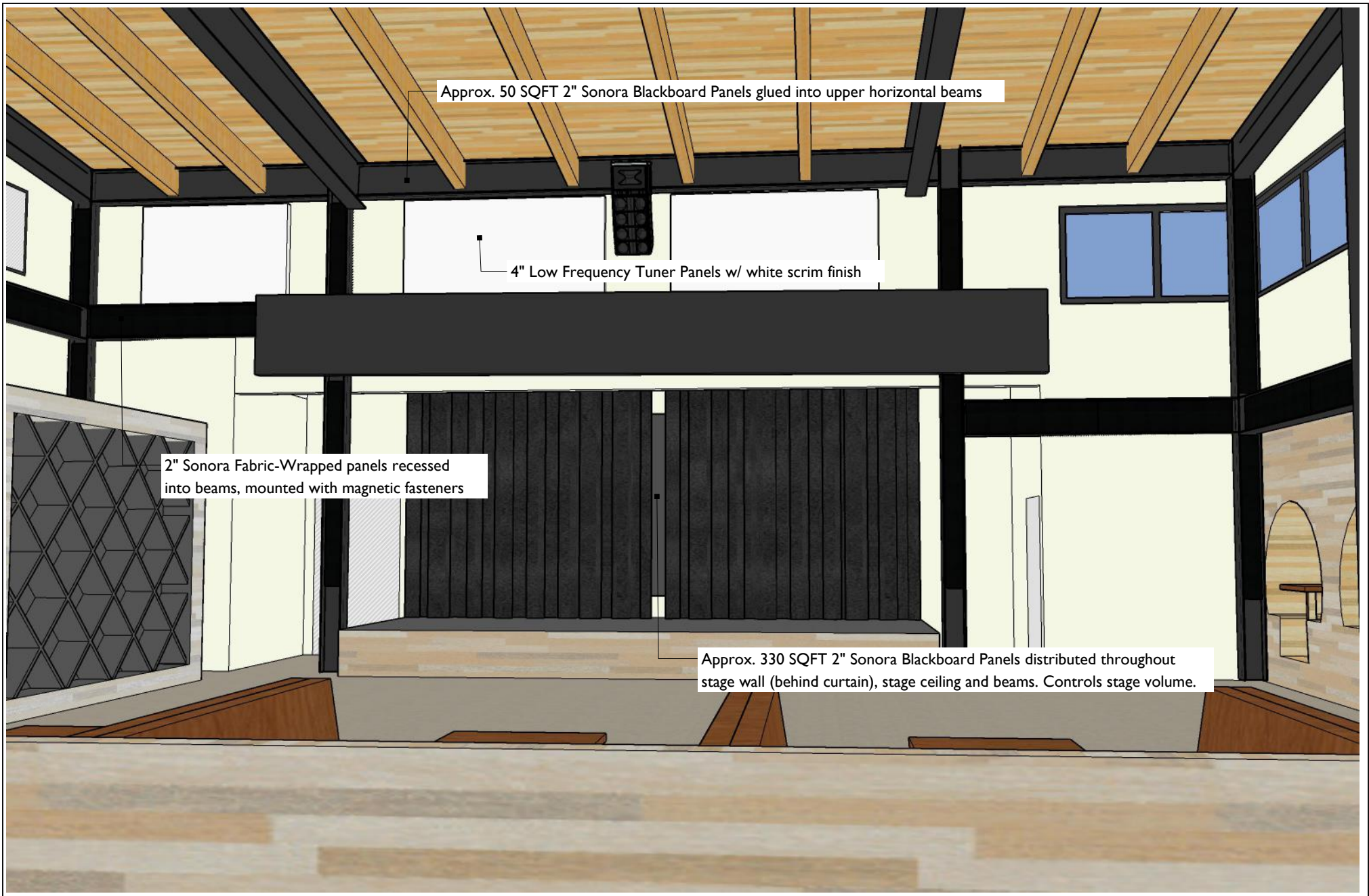

Approx. 50 SQFT 2" Sonora Blackboard Panels glued into upper horizontal beams

4" Low Frequency Tuner Panels w/ white scrim finish

2" Sonora Fabric-Wrapped panels recessed into beams, mounted with magnetic fasteners

Approx. 330 SQFT 2" Sonora Blackboard Panels distributed throughout stage wall (behind curtain), stage ceiling and beams. Controls stage volume.

Dogfish Head Brewings & Eats

Acoustic Treatment Recommendations

Cameron Girard - Acoustic Design Consultant

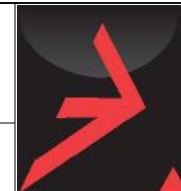

AcousticsFirst[®]
CORPORATION
2247 Tomlyn Street, Richmond, VA 23230
PH: (804) 342-2900 FX: (804) 342-1107
www.AcousticsFirst.com



Dogfish Head Brewings & Eats

Acoustic Treatment Recommendations

Cameron Girard - Acoustic Design Consultant

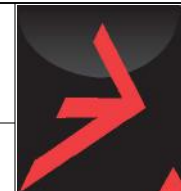

AcousticsFirst[®]
 CORPORATION
 2247 Tomlyn Street, Richmond, VA 23230
 PH: (804) 342-2900 FX: (804) 342-1107
www.AcousticsFirst.com

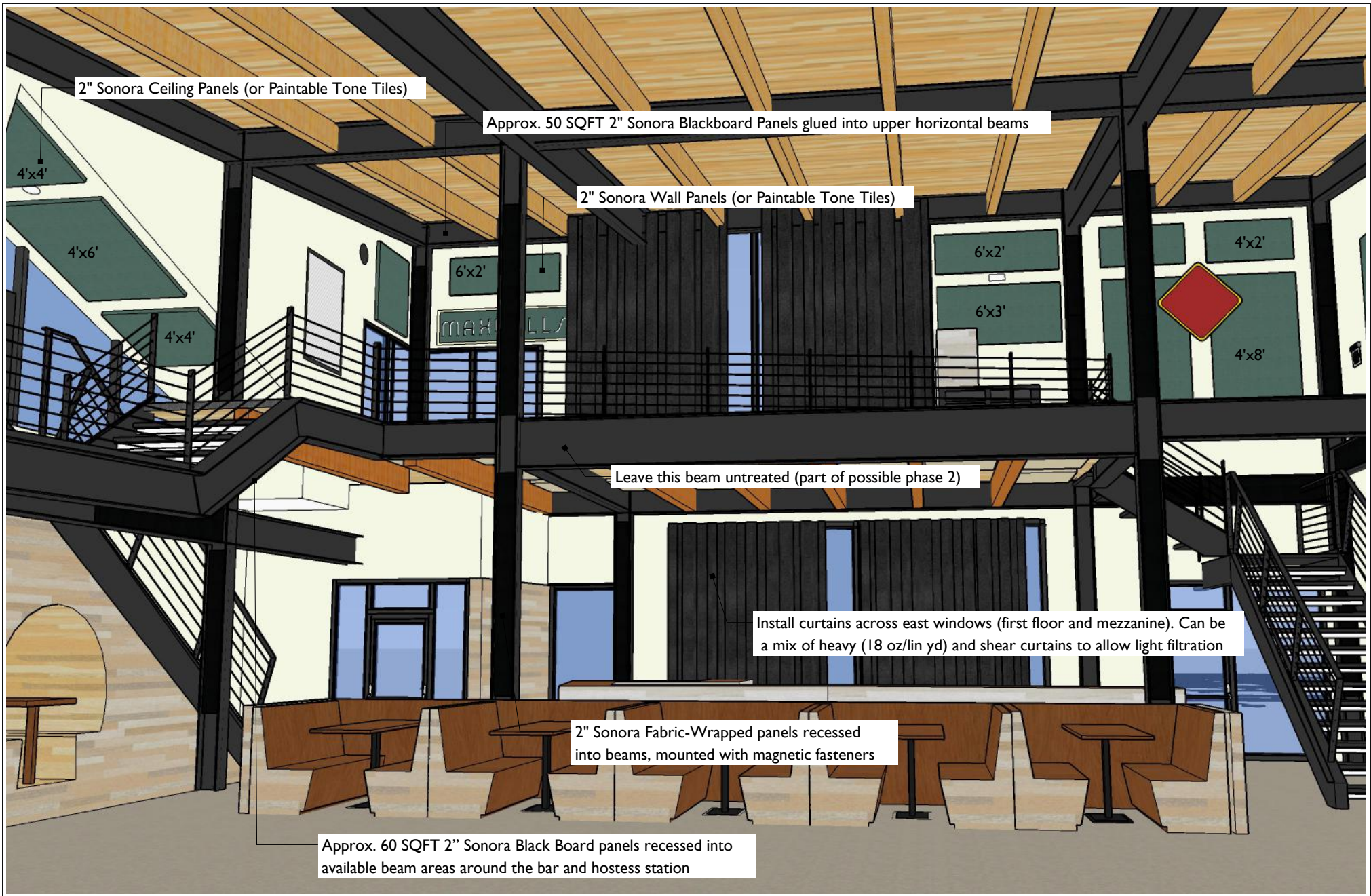

2" Sonora Ceiling Panels (or Paintable Tone Tiles)

Approx. 50 SQFT 2" Sonora Blackboard Panels glued into upper horizontal beams

2" Sonora Wall Panels (or Paintable Tone Tiles)

Leave this beam untreated (part of possible phase 2)

Install curtains across east windows (first floor and mezzanine). Can be a mix of heavy (18 oz/lin yd) and shear curtains to allow light filtration

2" Sonora Fabric-Wrapped panels recessed into beams, mounted with magnetic fasteners

Approx. 60 SQFT 2" Sonora Black Board panels recessed into available beam areas around the bar and hostess station

Dogfish Head Brewings & Eats

Acoustic Treatment Recommendations
 Cameron Girard - Acoustic Design Consultant



AcousticsFirst[®]
 CORPORATION
 2247 Tomlyn Street, Richmond, VA 23230
 PH: (804) 342-2900 FX: (804) 342-1107
www.AcousticsFirst.com

A 03

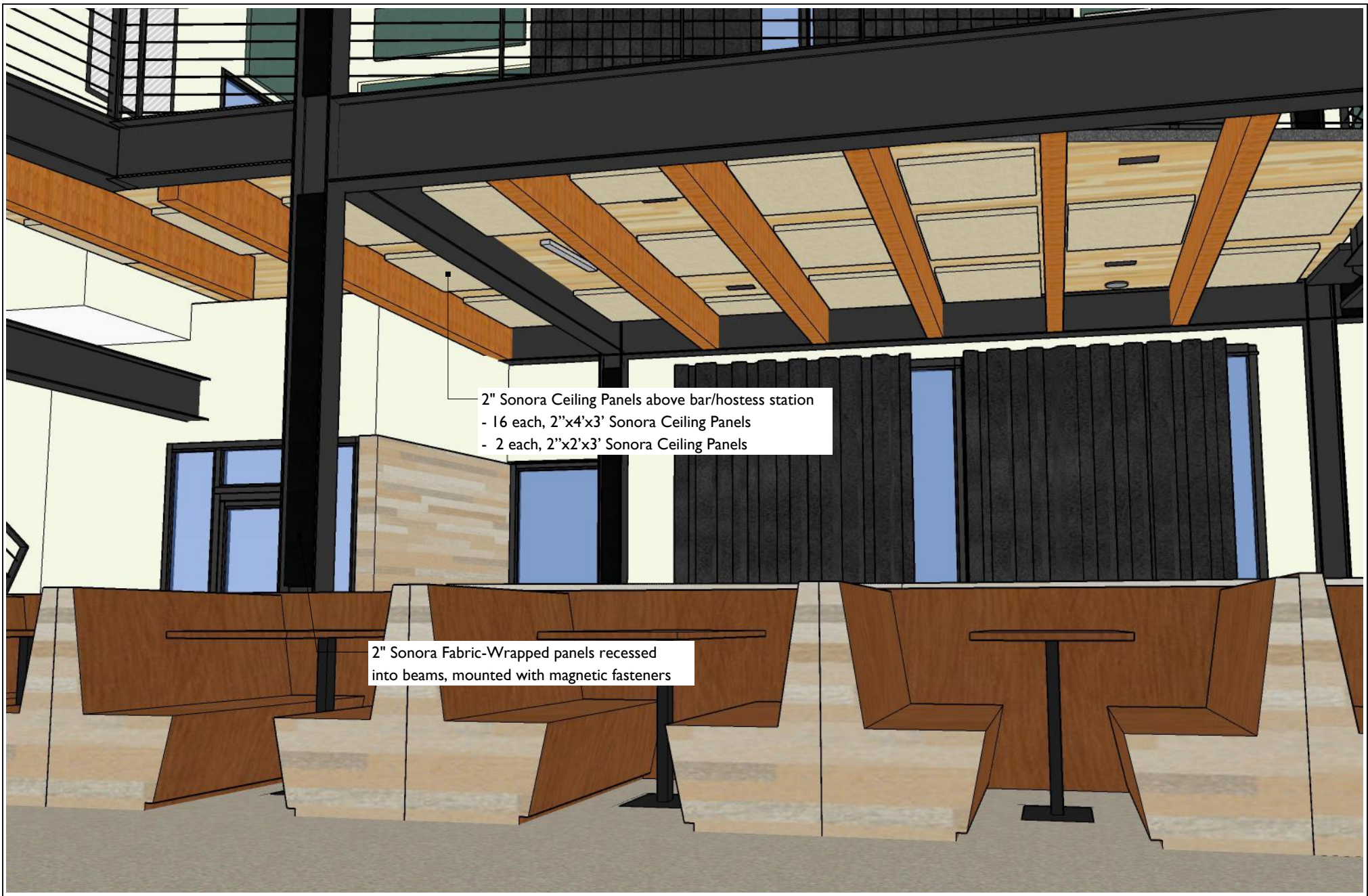

2" Sonora Ceiling Panels above bar/hostess station
- 16 each, 2"x4'x3' Sonora Ceiling Panels
- 2 each, 2"x2'x3' Sonora Ceiling Panels

2" Sonora Fabric-Wrapped panels recessed
into beams, mounted with magnetic fasteners

Dogfish Head Brewings & Eats

Acoustic Treatment Recommendations

Cameron Girard - Acoustic Design Consultant

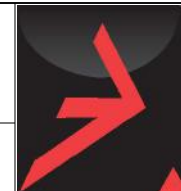

AcousticsFirst[®]
CORPORATION
2247 Tomlyn Street, Richmond, VA 23230
PH: (804) 342-2900 FX: (804) 342-1107
www.AcousticsFirst.com

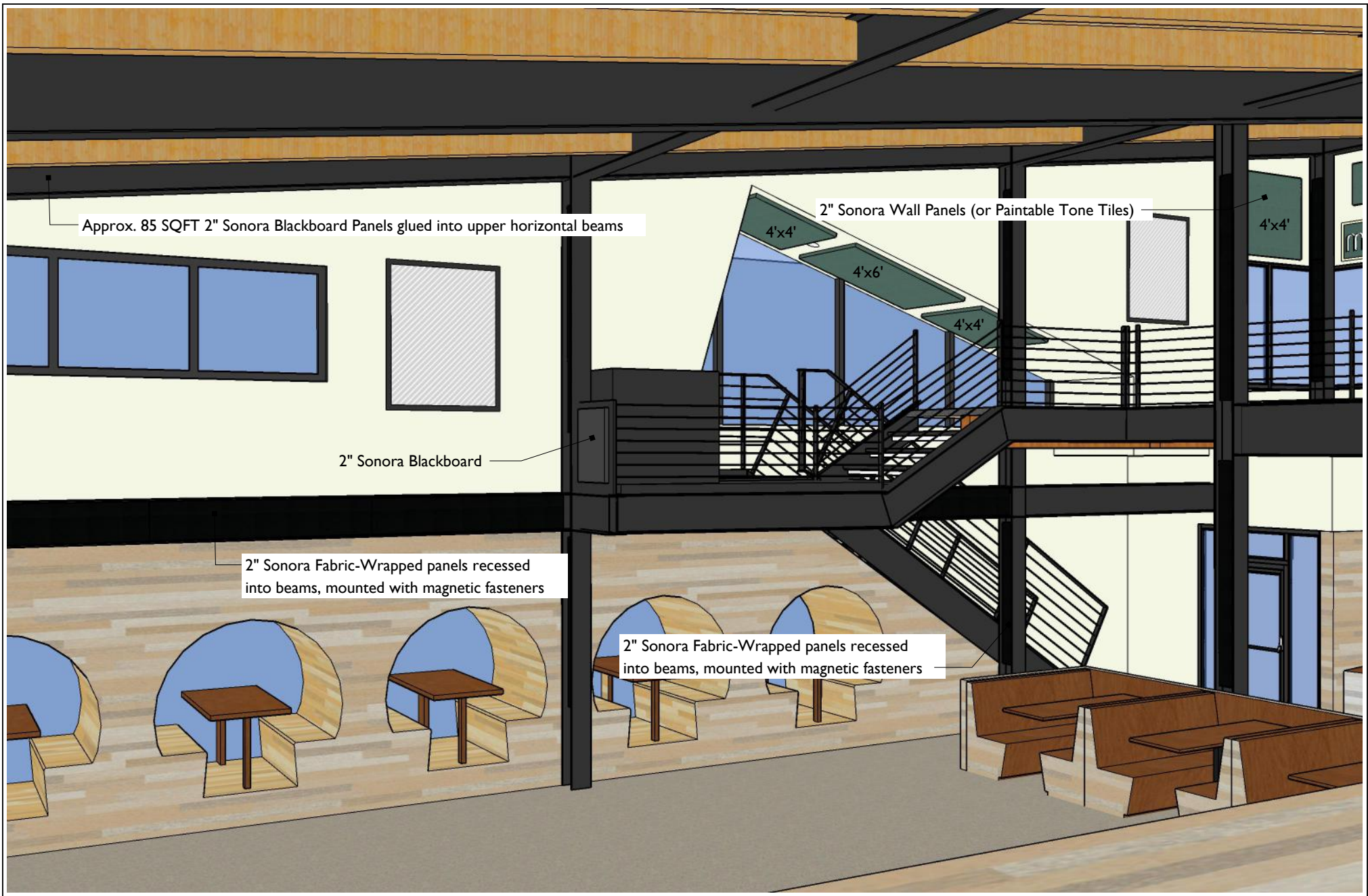

Approx. 85 SQFT 2" Sonora Blackboard Panels glued into upper horizontal beams

2" Sonora Wall Panels (or Paintable Tone Tiles)

2" Sonora Blackboard

2" Sonora Fabric-Wrapped panels recessed into beams, mounted with magnetic fasteners

2" Sonora Fabric-Wrapped panels recessed into beams, mounted with magnetic fasteners

Dogfish Head Brewings & Eats

Acoustic Treatment Recommendations

Cameron Girard - Acoustic Design Consultant

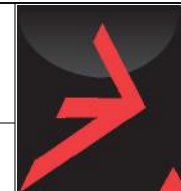

AcousticsFirst[®]
 CORPORATION
 2247 Tomlyn Street, Richmond, VA 23230
 PH: (804) 342-2900 FX: (804) 342-1107
www.AcousticsFirst.com



Approx. 660 SQFT 2" Sonora Blackboard Panels glued into ceiling beams (all sides)

Dogfish Head Brewings & Eats

Acoustic Treatment Recommendations

Cameron Girard - Acoustic Design Consultant



AcousticsFirst[®]
CORPORATION
2247 Tomlyn Street, Richmond, VA 23230
PH: (804) 342-2900 FX: (804) 342-1107
www.AcousticsFirst.com

A 06